

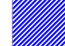

NOTES

1. Dimensions in meters, unless otherwise stated.
2. This drawing should be read in conjunction with other relevant engineering details, drawings & specifications.
3. Any discrepancies should be reported to the design engineer immediately, so that clarification can be sought prior to the commencement of works.
4. The dimensions must be verified on site before construction.
5. All works are to be in accordance with Southwark borough council specification and standards.

KEY

-  ANPR ZONE EXTENTS
-  PERMANENT CLOSURE
-  DIAGRAM 618.3 SIGNAGE
-  LOCKABLE MANCHESTER BOLLARDS

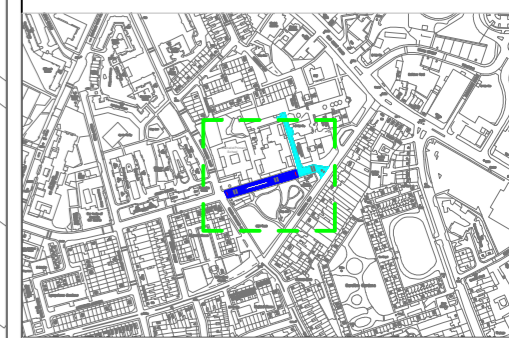
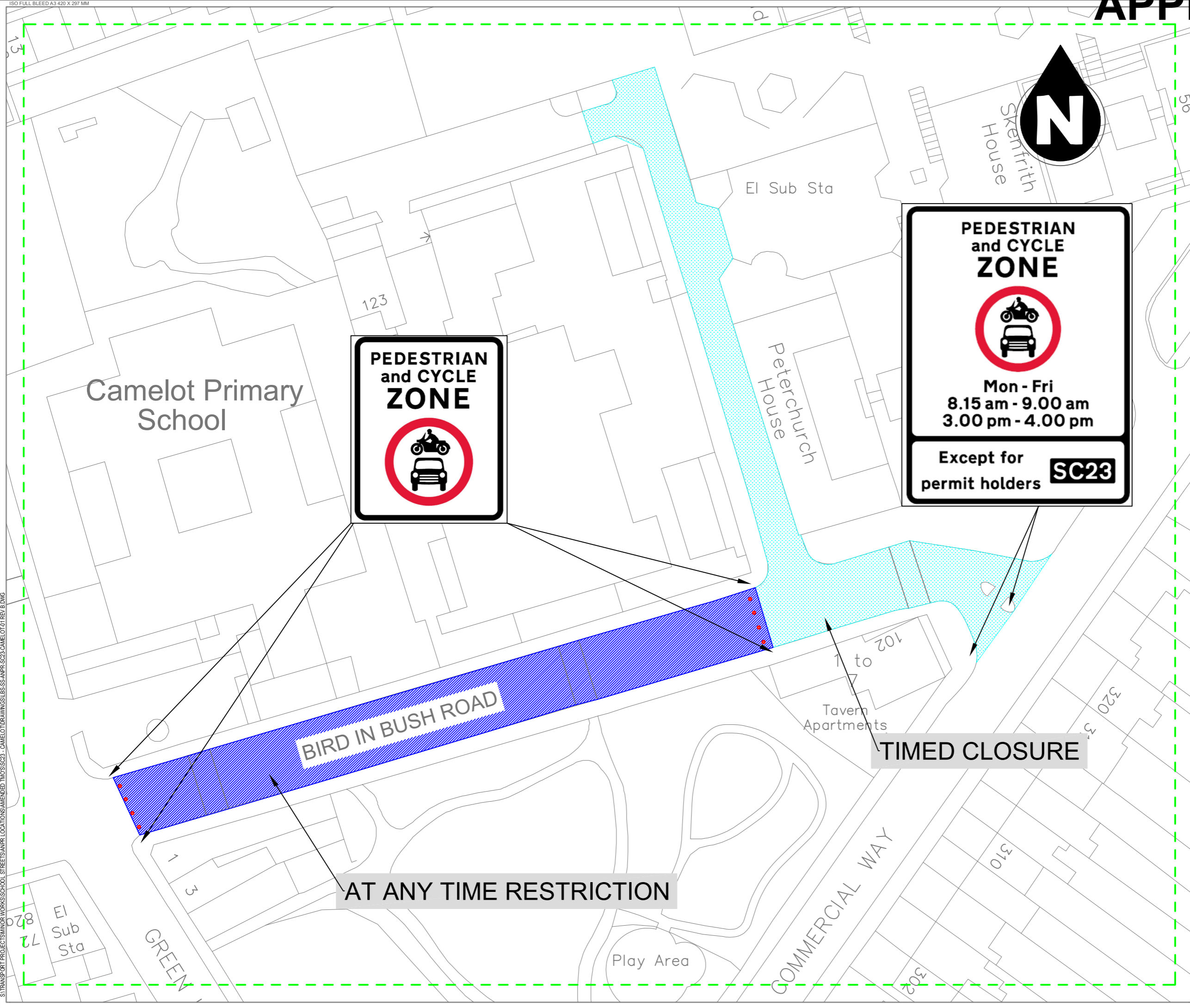

REV	DATE	REVISION DESCRIPTION / DETAILS	DRN BY	CHKD BY	APPRD BY
B	07.12.22	CHANGES TO CLOSURE EXTENTS	TA	GM	GM
A	04.11.22	OUTLINE DESIGN	TA	GM	GM



PROJECT: MINOR WORKS SCHOOL STREETS ANPR SC23 - CAMELOT PRIMARY SCHOOL

TITLE: MASTER PLAN

STATUS:	OD	DRAWN	TA
SCALE:	1:500 @ A3	DESIGNED	TA
DRAWING NO:	LBS/MW/BIRD_IN_BUSH_ROAD/01	CHECKED	GM
DATE DRAWN:	7 DEC 2022	APPROVED	GM
DATE ISSUED:	19 JAN 2024	REV:	B

S:\TRANSPORT PROJECTS\MINOR WORKS\SCHOOL STREETS\ANPR LOCATIONS\AMENDED TIMING\SC23 - CAMELOT PRIMARY SCHOOL\SC23-CAMELOT\01 REV 01.DWG